



*A joint project of*



Auswärtiges Amt





## JAMIAH MOSQUE THATTA TOWN THATTA

*Coordinates: 24°44'49.07"N 67°57'40.33"E*

SURVEY DATE  
19 DEC. 2013

### REFERENCES

# INVENTORY OF CULTURAL PROPERTY IN THE PROVINCE OF SINDH, PAKISTAN

1 Site/Monument: JAMIAH MOSQUE. THATTA TOWN

2 District: THATTA

3 Survey Date: 20/3/2019

4 GPS Location: (42R) 391601.1 E 2737365.4 N

PHOTO-POSITION PLAN (Please provide Scale, North, GPS Marking and Photo-position)

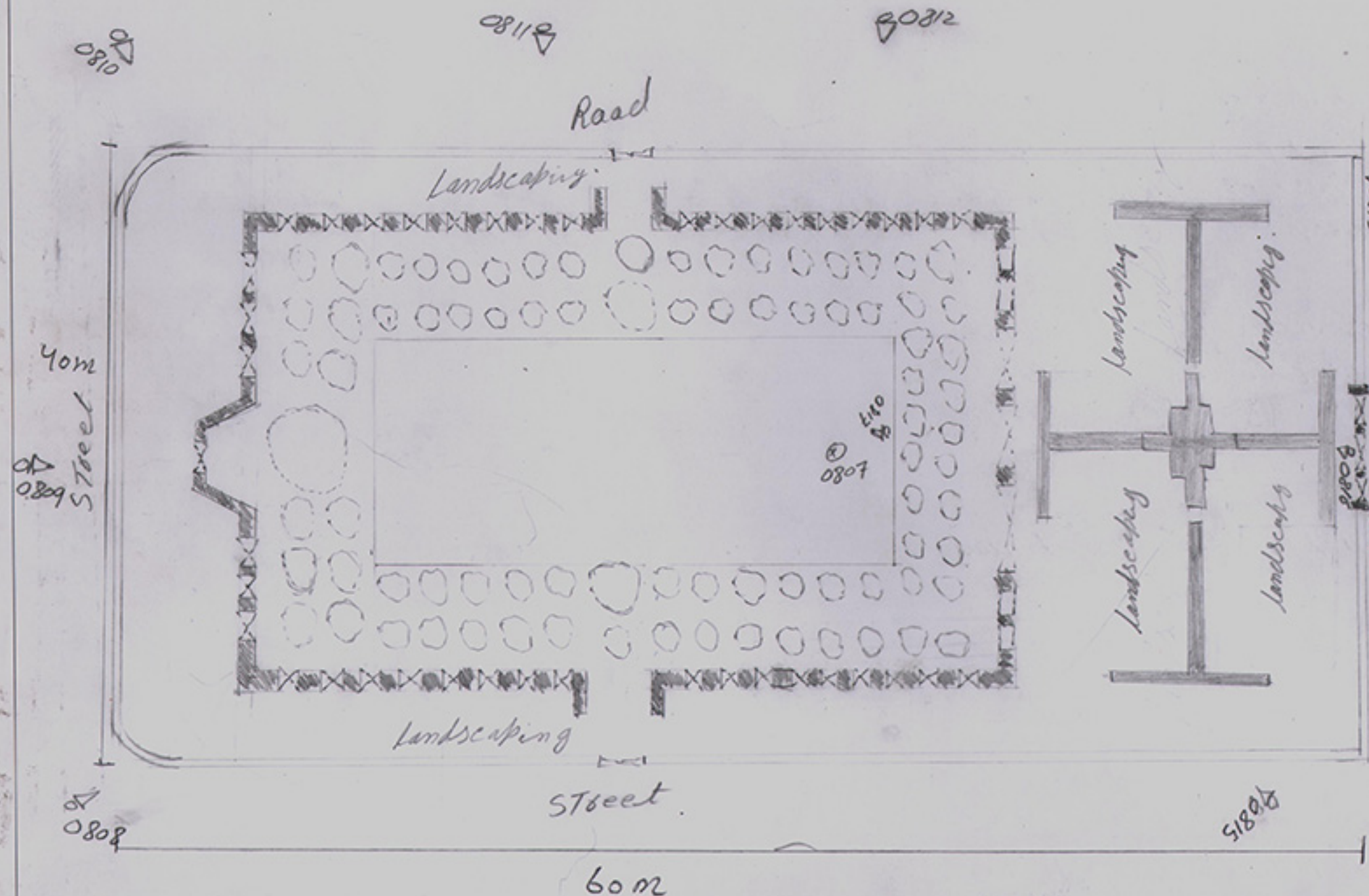

6 Sheet Code

JMTT 391601E 2737365.4N

7 Device Identification

14130475

Model Make: RICOH G700SE

8 Digital Photo-ID

9 Photo Description

RIMG10807	APPROX centre of the site
RIMG10808	view from S
RIMG10809	view from S-W
RIMG10810	view from W
RIMG10811	view from N-W
RIMG10812	view from N-W
RIMG10813	view from N-E
RIMG10814	view from N-E
RIMG10815	view from S-E
RIMG10816	view from N-E
RIMG10817	view from N-E inside the mosque.
RIMG10818	Front of the sheet
RIMG10819	Back of the sheet.

N

Scale:

☐ Measured Drawing

☒ Systematic Sketch

☐ Not to Scale

5 Drawn By:

SHOATIBALI

Date

20/3/2019

10 Recorded By:

SHOATIBALI

Date

20/3/2019





UTC 2013:12:19 08:48:42

42R E: 391615.1  
N: 2737369.4





UTC 2013:12:19 08:47:01

42R E: 391697.9  
N: 2737393.7





UTC 2013:12:19 08:44:56

428 E: 391678.2

N: 2737327.9





UTC 2013:12:19 08:42:37

42R E: 391765.8  
N: 2737408.1





UTC 2013:12:19 08:41:28

42R E: 391735.2  
N: 2737447.1





UTC 2013:12:19 08:39:59

42R E: 391652.2  
N: 2737438.7





UTC 2013:12:19 08:38:36

42R E: 391569.0  
N: 2737419.2





007 BOND

UTC 2013:12:19 08:37:44

42R E: 391524.3  
N: 2737397.6





UTC 2013:12:19 08:36:27

42R E: 391514.7  
N: 2737330.7





UTC 2013:12:19 08:35:37

42R E: 391544.6  
N: 2737292.4